

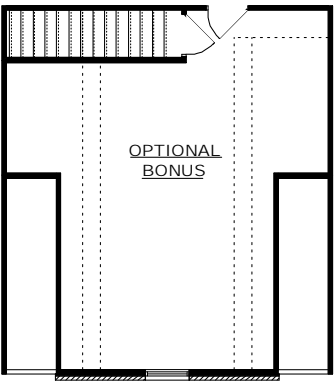

Brentwood

Joshua's Landing

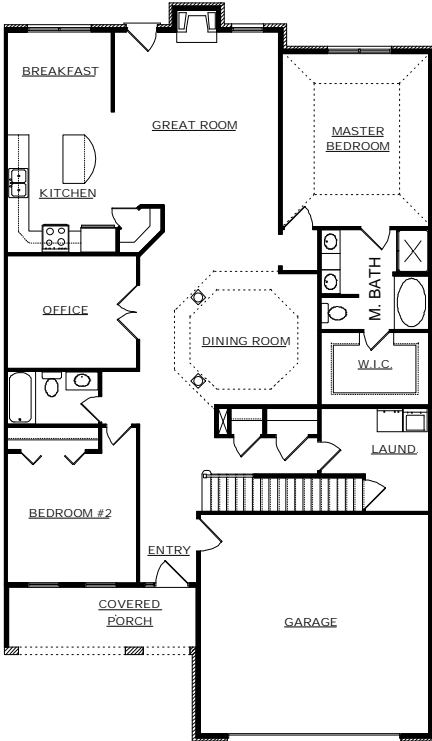

Total Heated SF: 1,916
 Floor 1 SF: 1,916
 Floor 2 SF:
 Bonus Room SF:
 Basement SF:
 Unfinished Bonus SF: 385
 Garage SF: 422
 Unfinished Basement SF:
 Unfinished Storage SF:

Floor plans and Elevations are subject to change. Floor plan dimensions are approximate. Consult working drawings for actual dimensions and information. Elevations are artist's conceptions. Builder reserves right to change or alter floor plans.

Please review specification sheet.
 Pricing subject to change without notice.

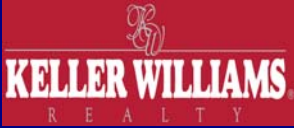

865-694-5904

Judy Teasley

865-599-9500



Room Sizes

| | |
|---------------------------|------------------|
| Master Bedroom: | 13'8x16 |
| Bed 2: | 12x12'1 |
| Bed 3: | N/A |
| Bed 4: | N/A |
| Master Bath: | 10x9'4 |
| Bath 2: | 8'6x5 |
| Bath 3: | N/A |
| Bath 4: | N/A |
| Half Bath: | N/A |
| Great/Family Room: | 15'5x18'6 |
| Dining Room: | 12'6x13'6 |
| Keeping Room: | N/A |
| Kitchen: | 9'8x11 |
| Breakfast: | 9'8x9'6 |
| Bonus Room: | 14x21 |
| Garage: | 21'8x20'5 |
| Storage: | N/A |
| Laundry: | 6x6 |
| Deck: | N/A |
| Patio: | 16x12 |
| Porch: | 18x6 |
| Office/Den: | 12x10'5 |

All room sizes and square feet listings are approximate.



Features

Features listed below are in addition to or in place of standard features listed on the specification sheet.

01. Low-maintenance exterior featuring brick and vinyl shakes
02. Ceramic tile bathrooms, laundry, kitchen, breakfast
03. Hardwood entry floor
04. Prewire for security system
05. NuWool insulation with a 25 year warranty
06. Main-Level Master bedrooms
07. Seperate tub and shower in master bathroom
08. Electric range, Microwave, and Dishwasher included
09. Crown molding throughout the first floor
10. Vented gas fireplaces with gas logs
11. Large base moldings throughout home
12. Optional Bonus Room
13. Optional Screen Porch
14. Optional Sun Room
15. Underground utilities
16. Sidewalks
17. Street Lamps
18. Knox County taxes